

# Hula Hoop

## Sospensione / Suspension

Design:

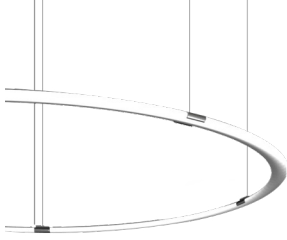

### Codice prodotto / Product code

Codice base Base code	Ottica Optic	Fissaggio Fixing	Colour T (K)	Finitura Finish	Chiusura Closing
HH2 -	O opale / opal	SP	Z 2700K	01	D069
			C 3000K		D090
			N 4000K		



Il codice prodotto si compone mettendo in fila, da sinistra a destra, i dati contenuti nelle colonne a partire da "Codice base".

The product code is created by putting in sequence the data starting from "Base code", from left to right.

01 Bianco White	02 Nero Black	07 Oro Gold
--------------------	------------------	----------------

### Specifiche generali / General Specifications

Tipologia di prodotto / Product type	Lampada LED / LED Lamp
Accessori di montaggio / Mounting accessories	Kit sospensione / Suspension Kit
Luogo di montaggio / Place of assembly	Soffitto / Ceiling
Ambiente di installazione / Installation location	Interni / Indoor

Sezione profilo / Profile section

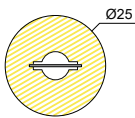

Misure in mm / Size in mm

Peso / Weight

-D069 0699	-D090 0904
1,50 Kg	2,00 Kg

### Specifiche illuminotecniche / Lighting specifications

Dimensione Size (mm)	LED Lumen	Product Lumen		Watt	Vdc	Colour T	CRI
		opal	prismatic				
Ø699	8278	4139	-	67,5	24	2700	93
	8714	4357	-	67,5	24	3000	93
	9150	4575	-	67,5	24	4000	93
Ø904	10721	5361	-	88	24	2700	93
	11285	5643	-	88	24	3000	93
	11850	5925	-	88	24	4000	93

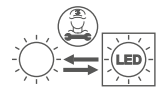

Efficienza L.O.R. / Efficiency L.O.R.	50
SDCM / SDCM	3
Durata di vita della lampada (h) / Life time (h)	L80B50 50.000

Prodotto contenente una sorgente di classe energetica F (2700K) / Product containing a source of energy class F (2700K)

Prodotto contenente una sorgente di classe energetica F (3000K) / Product containing a source of energy class F (3000K)

Prodotto contenente una sorgente di classe energetica F (4000K) / Product containing a source of energy class F (4000K)

### Specifiche fisiche / Physical specifications

Corpo / Body	Alluminio / Aluminium
Dispositivo ottico / Optical device	Policarbonato opale / Opal
Finiture / Finishes	Verniciato / Varnished

### Specifiche elettriche / Electrical Specifications

Cavo / Cable	Cavo FEP+PVC trasparente 2x0,5mmq L=1m uscita cavo posteriore Cable FEP+PVC transparent 2x0,5mmq L=1m back cable outlet
Alimentatore / Driver	Remoto da ordinare separatamente / Remote to be ordered separately
Dimmer / Dimmer	Remoto da ordinare separatamente / Remote to be ordered separately

### Specifiche ottiche / Optical Specifications

Distribuzione luminosa / Light distribution	Simmetrica / Symmetric
Emissione / Emission	Diretta / Direct
Puntamento / Pointing	Fisso / Fixed
Fascio luminoso / Light Beam	Diffuso / Diffused
U.G.R.	Opale/Opal < 24

### Accessori da ordinare separatamente / Accessories to be ordered separately

07250	Output 24Vdc 75W On/Off (170x45x29 mm)
CT00050	Dimmer 1 ch DALI2-PUSH-0/1..10V (41x47x20 mm)
CT00052	Dimmer 1 ch PUSH/WIRELESS (41x47x20 mm)

### Dettagli sospensioni / Suspension details

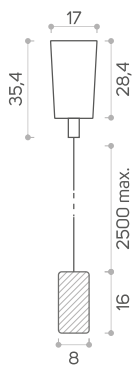

Ø699 - n.4 sospensioni / suspension

Ø904 - n.4 sospensioni / suspension

### Dettagli rosone / Canopy details

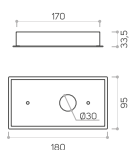

**Rosone porta alimentatore / Square canopy**

**AC00362\_00001** Bianco / White

**AC00362** Nero / Black

**AC00362\_00004** Oro / Gold

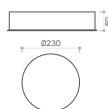

**Rosone porta alimentatore / Round canopy**

**AC00385** Bianco / White

**AC00385\_00002** Nero / Black

**AC00385\_00004** Oro / Gold

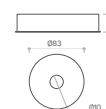

**Rosone copricavi / Cable cover canopy**

**AC00262** Bianco / White

**AC00320** Nero / Black

Ø83 mm

### Dettagli driver e dimmer / Driver and dimmer details

AL00179 Output 24Vdc 75W On/Off (170x45x29 mm)

CT00050 Dimmer 1 ch DALI2-PUSH-0/1..10V (41x47x20 mm)

CT00052 Dimmer 1 ch PUSH/WIRELESS (41x47x20 mm)